

AUTOMA INDUSTRIAL PRESSURE GAUGE

Model : AG52 (Dry) / AG58 (Oil Filled)

AG52 (Dry) & AG58 (Oil Filled) with bayonet casing models are designed for corrosive environment which do not have high viscosity or do not crystallize. Typical applications include chemical, petrochemical, refining, marine, food industry and etc. Systems or equipment with pulsating pressure or mechanical shock & vibration are apparent, the oil filled model is recommended.



Standard Specification

Dial Size (Nominal Diameter)

63, 100, 160mm (2.5", 4", 6")

Scale Range (kgf/cm², psi, bar, kPa, MPa)

-1 bar ~ 0 to 0 ~ 1000 bar

Process Connection

63mm : 1/8", 1/4" BSPT, NPT & BSPF

100 and 160mm : 3/8", 1/2" BSPT, NPT & BSPF

Threaded entry - Bottom or Back

Blow Protection

Back, Rubber Disc for 100 and 160mm

Top Rubber Disc for 63mm

Degree Protection

IP 65

Working Pressure

Steady : 75% of Full Scale

Over Range Protection : 130% of Full Scale

Working Temperature

Ambient : -20 ~ 65°C

Fluid : Max 200°C, (-20 ~ 80°C for Oil Filled model)

Accuracy

63mm : ± 1.6% of Full Scale

100, 160mm : ± 1.0% of Full Scale

Element

SS316 (100 & 160mm)

<100bar : C type Bourdon Tube

>=100bar : Helical Type Bourdon Tube

SS316 (63mm)

<60bar : C type Bourdon Tube

>=60bar : Helical Type Bourdon Tube

Material

Case & Cover : Bayonet type, SS304

Window : 63mm-Glass

: 100&160mm-Tempered / safety Glass

Connection : SS316L

Movement : SS304

Dial Plate : White Aluminum with Black Graduations

Pointer : Aluminium alloy, Black painted

Blowout : NBR

Oil Filling : Glycerin oil/ Silicon oil(option)

Pressure Gauge Ordering Information

Model	Mounting Type	Dial Size	Range	Unit	Connection	Type
AG52	A : Direct bottom connection	63mm (2.5")	0~1, 0~2, 0~3, 0~4,	Bar	1/4"	BSPT
AG58	B : Bottom with case surface mounting	100mm (4")	0~6, 0~10, 0~16,	Mpa	3/8"	BSPF
	G : Lower back (100 & 160mm)	160mm (6")	0~20, 0~25, 0~35,	Bar & Psi	1/2"	NPT
	F : Center back (63mm)		0~40, 0~50, 0~60,	kgf/cm ² & Psi		
	N : Lower back, flush, cover mounting plate		0~70, 0~100, 0~160,			
			0~250, 0~350, 0~400,			
			0~500, 0~600, 0~700,			
			0~1000.			

Options

Oil Filled

Adjustable Pointer

Damper Movement

Maximum pointer

Red Pointer

Example of Order

AG52 - 100 - A04 - 010 (0-10bar/150 psi - 1/2" NPT)

Basic Dimensions

CODE A

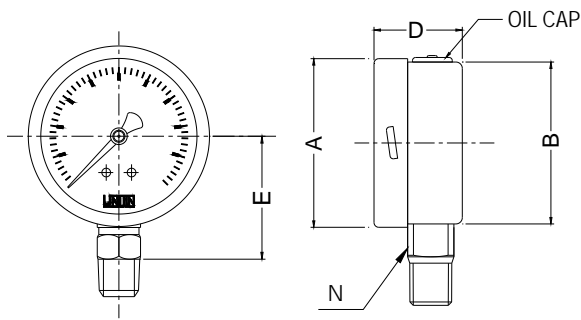

A: Direct bottom connection

Unit : mm

	ø 63	ø 100	ø 160
A	64.0	100.6	160.6
B	62.0	98.6	159.0
D	32.7	49.5	52.5
E	41.0	65.0	94.0
N	14.0	22.0	22.0

CODE B

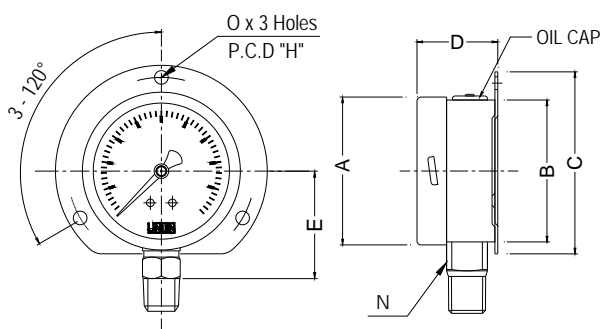

B: Bottom connection with surface mounting plate

Unit : mm

	ø 63	ø 100	ø 160
A	64.0	100.6	160.6
B	62.0	98.6	159.0
C	79.0	122.0	196.0
D	35.7	53.3	56.0
E	41.0	65.0	94.0
H	78.4	117.5	178.0
N	14.0	22.0	22.0
O	4.3	6.0	6.0

CODE G

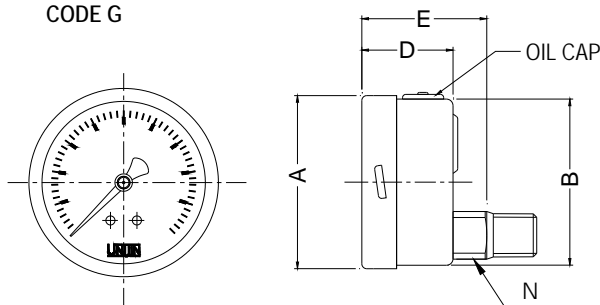

G: Lower back connection

Unit : mm

	ø 100	ø 160
A	100.8	160.6
B	98.8	159.0
D	49.6	52.5
E	62.0	67.5
N	22.0	22.0

CODE N

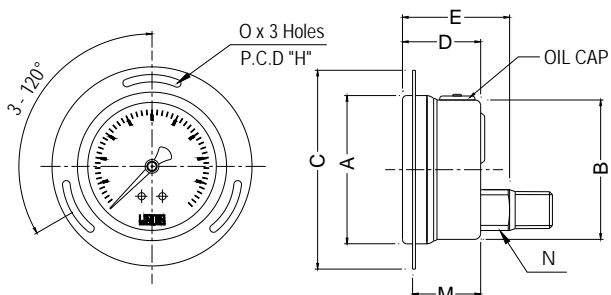

N: Lower back connection with panel mounting plate

Unit : mm

	ø 100	ø 160
A	100.8	160.6
B	98.8	159.0
C	130.5	196.0
D	49.6	52.5
E	62.0	67.5
H	116.0	178.0
M	45.0	47.5
N	22.0	22.0
O	6.0	6.0